



RB-100 – Tankless Water Heater Recess Box Installation Instructions

This enclosure is for the MWH180EX only

This manual provides the installer with basic instructions necessary to properly install the recess box. This manual assumes that the installer has basic carpentry skills and plumbing knowledge. Follow local codes that may apply to this installation, all local building, electrical, and plumbing codes should be followed.

It is important that the installer of this recess box read these instructions along with the instructions provided with the tankless water heater.

WARNING! Gasoline, as well as other flammable materials and liquids (adhesives, solvents, paint thinners etc.), and the vapors they produce are extremely dangerous. **DO NOT** handle, use or store gasoline or other flammable or combustible materials anywhere near or in the vicinity of a water heater or any other appliance. Be sure to read and follow the labels on the water heater, as well as the warning printed in the manual. Failure to do so can result in property damage, bodily injury or death.

Location – This water heater recess box is for **OUTDOOR** installation **ONLY**, and is intended for use only with the water heater listed above. Do not attempt to install a water heater of another brand or model in this recess box. Do not attempt to modify this recess box, doing so will alter the intended design, potentially causing an unsafe operating condition.

Consult the installation and operating instruction manual provided with your tankless water heater for installation instructions regarding a suitable location for the water heater. All guidelines regarding clearances and distances from overhangs, windows and doors, and air inlets into the home must be followed.

Recess Box Clearances – This recess box is designed to be installed with a Zero (0) clearance to combustibles. For service and proper operation, 24 inches of clearance is required in front of the recess box.

Freeze Protection – To help prevent water lines from freezing do not locate the water heater on the side of a building with prevailing winter winds. Refer to the installation and operating instruction manual provided with your water heater for additional information.

Recess Box Location – This water heater recess box is intended for an outdoor location only. Follow the guidelines below or in the installation and operating instructions provided with the water heater for choosing a suitable location.

Water Heater Exhaust Terminal Location – The following information should be used for determining the proper location of the vent terminal for outdoor tankless water heaters.

Additional Considerations

1. Do not install water heater under any patio or deck
2. To help prevent moisture from freezing on walls and under eaves, as well as water lines, do not locate the water heater on the side of a building with prevailing winter winds
3. Do not locate water heater too close to shrubbery, as flue gases may damage them
4. Guard exhaust vent against accidental contact with people and pets
5. Install the water heater so that the air inlet and exhaust vent are above anticipated snow levels

Rough In Dimensions – Height, width and depth are listed below. Protrusion on the outside depends on siding and stud thickness.

Dimensions (Figure 1)

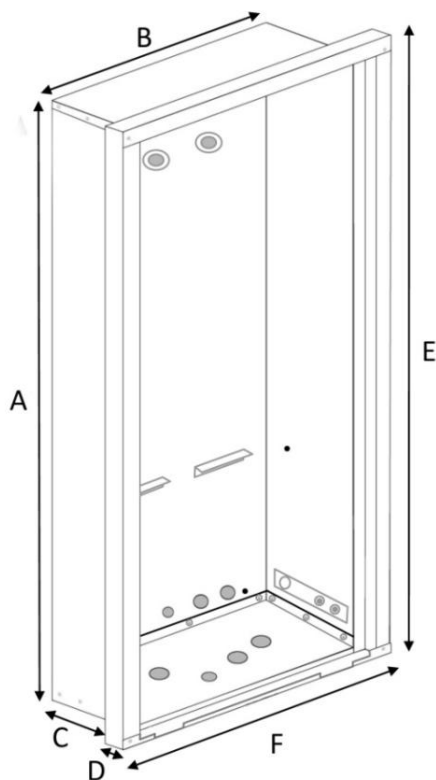

A	B	C	D	E	F
38 1/2"	14 5/16"	5 7/8"	1 1/2"	39 15/16"	17"

Installation – The recess box is designed to be installed with a variety of home exterior products for new or existing construction.

1. Choose a suitable location for the water heater and recess box. Follow the guidelines of this manual, and the installation and operating instructions for the water heater, regarding location and clearances. Cut an opening in the exterior wall of the home for the rough-in dimensions in Figure 1. Local building codes and standard building practices should be followed.
2. Install the recess box into the opening, level and square the box, use shims if necessary. Test fit the outer door to make sure it does not bind during installation. Secure the recess box to the framing on each side using four or more self tapping screws (not provided).
3. Mount the water heater into the recess box. In the lower back of the recess box are two channels to support the bottom mounting bracket of the water heater. At the top are two retaining studs for securing the top mounting bracket. Lift the water heater up, slide the bottom mounting bracket down into the channels, and, at the same time, hook the top bracket over the retaining studs. Once the plumbing pipes are hooked up they will lock the unit in place.

Plumbing and Piping (Figure 2)

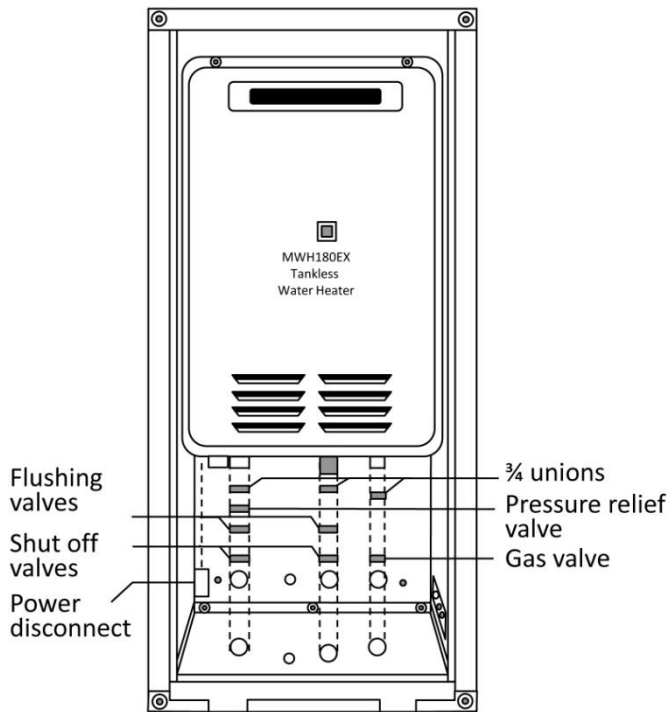

Note: To ease installation we recommend the use of combination isolation valves

Power Disconnect – Install a suitable means to disconnect power from the unit for service. This disconnect should be weather resistant and meet any and all local codes. In the absence of local codes, the National Electrical Code should be followed. Refer to the installation and operating instructions to connect the power to the water heater.

Remote Controller Wiring – 18 gauge thermostat wire(s) should be used and routed through any hole except the hot water opening. Connect wires to the water heater according to the installation and operating instructions.

Seal all openings around pipes and wires with an outdoor grade silicone sealant. Seal the joint between the recess box and the siding or brick of the house with a silicone based sealant to prevent water from getting behind the box and into the wall.

Final Assembly and Inspection – Follow the installation and operating instructions for complete details about the water heater. Check all water and gas connections for leaks.

Follow installation and operating instructions for installation of gas and water lines. Knock out holes are provided in both the bottom and back to accommodate most piping and wiring applications. These holes line up with the fittings coming off of the bottom of the water heater.

1. Stub the water lines and gas pipe up through the bottom or back of the box. It is recommended that shut off valves and unions be installed in the piping for future service.
2. Connect the water lines and gas piping to the water heater in accordance with the installation and operating instructions provided with the water heater.
3. Seal around the piping and silicone any unused knock outs to prevent any water from leaking into the wall behind or below the recess box. Insulate water pipes with insulation suitable for hot water.

Typical Installation and Finish (Figure 3)

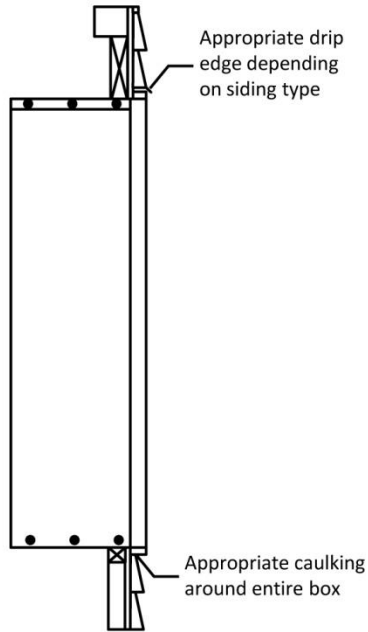

Clapboard, vinyl, stone or brick siding

Installing the Door – Lift the door up from the bottom at a slight angle. Slip the door into the channel at the top of the recess box. Next, push the bottom of the door flush with the recess box and slide down into the channel at the bottom of the enclosure. Do not block any air openings of the door.

Warning – All openings in the bottom of the recess box must be sealed (see figure 4) to prevent water infiltration into the wall. Failure to do so could result in damage to the wall.

Locking Tab – If using the locking tab, attach it over the two threaded studs on the lower right hand side of the cabinet (see figure 4). Secure it by tightening the two nuts provided onto the two studs. Lift the door into place per the instructions below. As the door is being slid down into place, guide the locking tab into the slot in the bottom of the door.

Once the tab is in place, secure with suitable means (small padlock, security tag, etc.).

Locking Tab (Figure 4)

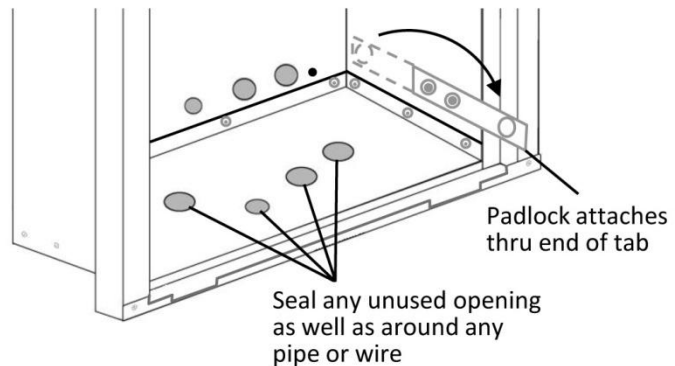

Monitor Products, Inc.

P.O. Box 3408
Princeton, New Jersey 08543
Phone (732) 329-0900
www.monitorproducts.com
E-mail: info@monitorproducts.com